

**Experience, Knowledge, Drive and Service**

We are an Independent Estate Agency with a great wealth of experience. Covering Chessington, North Cheam, Morden, Worcester Park, Stoneleigh, West Ewell and Epsom, the partners have well over 150 years of experience in the industry, many of which have been spent working locally. We feel that we bring many great characteristics to the marketplace, in particular the 'know how' required to deliver excellent results, the drive required to work as hard as it takes for our customers and a real desire to deliver superb levels of service. We know that moving house, or indeed letting one, can be complicated and stressful. We also respect that in many cases we are dealing with your home and all the emotional ties that go with it. We understand and will always do what it takes to make matters run as smoothly as possible. We offer a comprehensive list of services including Sales, Lettings and Mortgage Advice. Whatever your circumstances and plans, please contact us, we will be only too happy to help and all of our advice and guidance is free. All of our valuations and lettings appraisals are also free and we operate a no sale/let - no fee policy

- Knowledgeable team with over 150 years experience
- All viewings accompanied
- No upfront fees and no sale/let - no fee policy
- Superb internet coverage with free enhanced marketing packages
- Computer linked offices
- Floorplan and video tours on most Property Details
- Tailored service levels for Landlords
- Agreed sales fully managed through to completion
- Always competitive on fees

**Free Valuations**

If you are considering selling or letting your property we can carry out a free, no obligation valuation and market appraisal. Rest assured that with our unrivalled experience and local knowledge you will be given expert information, advice and guidance.

**Mortgage Advice**

We have a free Mortgage Service available from our Independent Financial Adviser. We can advise on products from the whole of the mortgage market and of course the whole process is managed from application to completion including regular progress updates for all our clients.

**18 Mole Court, West Ewell, Surrey**

- Three Bedrooms
- Large Lounge
- Fitted Kitchen/Dining Room
- Cul-de-Sac Location
- Downstairs W/C
- Viewing Recommended

**£399,950**



**Ground Floor**

Approx. 47.3 sq. metres (509.2 sq. feet)

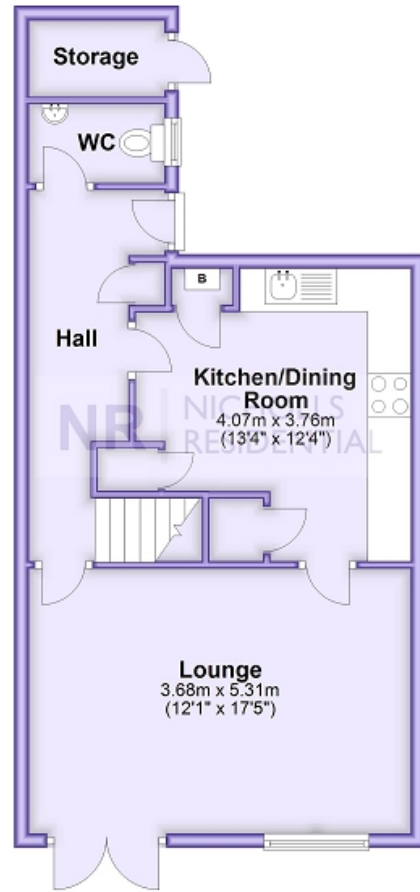

**First Floor**

Approx. 42.1 sq. metres (452.7 sq. feet)

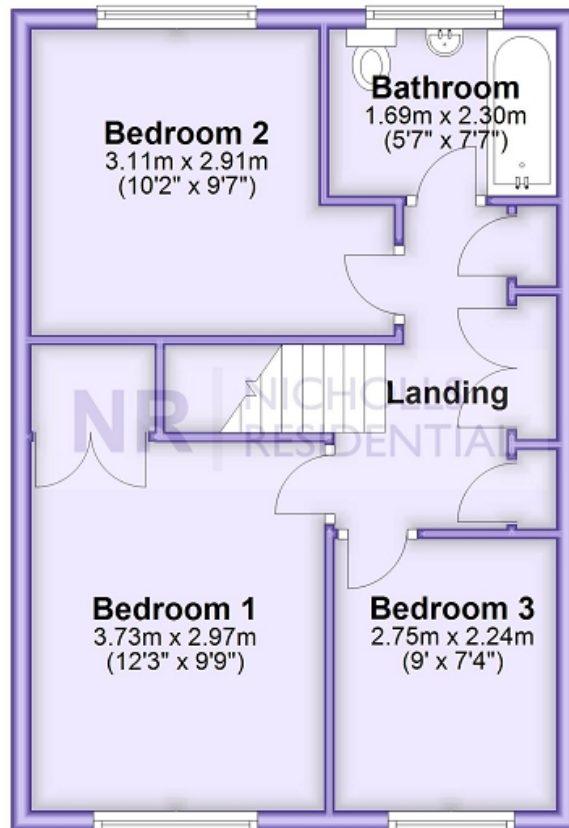

This floor plan and related floor plans are for layout guidance only. Not drawn to scale unless stated. All measurements are approximate. Whilst every care is taken in the preparation of this plan, please check all dimensions before making any decision reliant upon them.

Nicholls Residential are pleased to offer to the market this three bedroom family home situated in a cul-de-sac in Mole Court close to the wide open space of the Hogsmill nature reserve. The accommodation to the ground floor comprises a WC/ cloakroom, a modern 13'4" x 12'7" kitchen/ dining room fitted with wall and base units with amply work surface above, a good sized 17'5" x 12' lounge set to the rear of the property with direct access to the low maintenance court yard garden. To the first floor there are three bedrooms, two of which are doubles and a the third is a good size single completing this floor is the 3pc family bathroom fitted with a white suite and tiled walls. Outside the rear courtyard garden is paved with shrub borders. To the front there is brick storage cupboard, lawned area with shrub borders and a wooden picket fence. Call us to arrange your appointment to view this property.



Energy Efficiency Rating		Current	Potential
Very energy efficient - lower running costs			
(92+)	<b>A</b>		
(81-91)	<b>B</b>		86
(69-80)	<b>C</b>	73	
(55-68)	<b>D</b>		
(39-54)	<b>E</b>		
(21-38)	<b>F</b>		
(1-20)	<b>G</b>		
Not energy efficient - higher running costs			
England, Scotland & Wales		EU Directive 2002/91/EC	

The energy efficiency rating is a measure of the overall efficiency of a home. The higher the rating the more energy efficient the home is and the lower the fuel bills will be.

